

# Front Mounting Switches

# sälzer

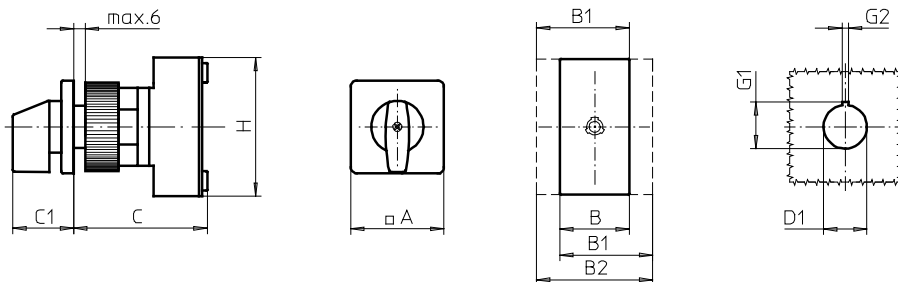
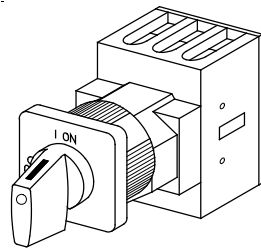

**Product lines  
H200-A/-B/-C**

**Front mounting switch**

**Single hole mounting**  
ø 30,5 mm

**209M1** (IP66)

Complete switch	Poles	Product lines	Rated data (IEC 60947)			Order code number
			Operational current I <sub>e</sub>	Operational power at 380–440V		
			AC-21A A	AC-23A kW	AC-3 kW	
ON-OFF Switches Switching angle 90°	3 ... 4	H200-C	20	5,5	3,7	<b>H212 - 41 ... - 209M1</b>
		H200-A	20	5,5	3,7	<b>H216 - 41 ... - 209M1</b>
	3 ... 4	H200-B	25	7,5	5,5	<b>H220 - 41 ... - 209M1</b>
			32	11	7,5	<b>H226 - 41 ... - 209M1</b>
			40	15	11	<b>H233 - 41 ... - 209M1</b>
			63	22	18,5	<b>H263 - 41 ... - 209M1</b>

## SMD modules for basic switch A01

Mounting form module for 209M1	H200-A H200-B/-C	<b>BFA2 - 219</b> <b>BFB2 - 219</b>
M-operator module 48 x 48 mm, mounting form 209M1 Escutcheon black, handle black	H200-A/-B/-C	<b>2DM1 - 30</b>
Legend plate silver, operator module 209M1		<b>FAS2 - 9...</b> (FA number)

## Dimensions (mm)

Product lines	A	B	B1	B2	C	C1	D1	G1	G2	H
H200-A	48	36	48	60	75	32	30,5	33	4,8	70
H200-B	48	50	69	88	75	32	30,5	33	4,8	72
H200-C	48	45	-	-	70	32	30,5	33	4,8	45