

Front Mounting Switches

sälzer

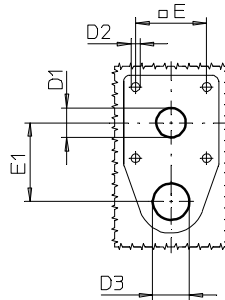
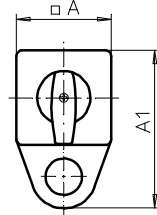
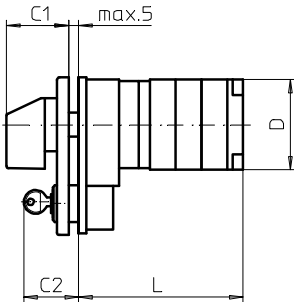
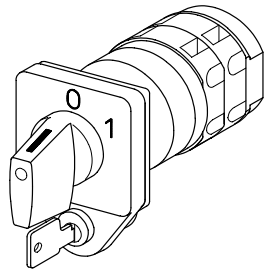

Product lines
M200 / T200

Front mounting switch
With cylinder lock device
Key number CL1

Four hole mounting
36 x 36 mm

060M1 (IP40)

Complete switch	Poles	Product line	Rated data (IEC 60947)			Order code number
			Operational current I _e	Operational power at 380–440 V		
			AC-21A A	AC-23A kW	AC-3 kW	
Rotary Cam Switches	1 ... 24	M200	20	7,5	5,5	M220 - 61 ... - 060M1
Switching angle 30°/45°/60°/90°			25	11	7,5	M225 - 61 ... - 060M1
Position "OFF" or start position locked	1 ... 24	T200	32	15	11	T225 - 61 ... - 060M1
Other locking arrangements available; please specify upon request						
2 keys, keylockable in selected position						

SMD modules for basic switch		
Mounting form module for 060M1	M200 / T200	BFA2 - 060
M-operator module, mounting form 060M1		2OM1
Escutcheon black, handle black		
Legend plate silver, operator module 060M1		FAS2 - (FA number)

Dimensions (mm)											L with ... stages (max. 12)				each add. stage
Product lines	A	A1	C1	C2	D	D1	D2	D3	E	E1	1	2	3	4	
M220	48	80	32	40	46	15	4,5	19	36	40	54	64	74	84	10
M221	48	80	32	40	46	15	4,5	19	36	40	57	70	83	96	13
M225	48	80	32	40	48	15	4,5	19	36	40	57	70	83	96	13
T225	48	80	32	40	50	15	4,5	19	36	40	59	74	89	104	15