

# Front Mounting Switches

**sälzer**

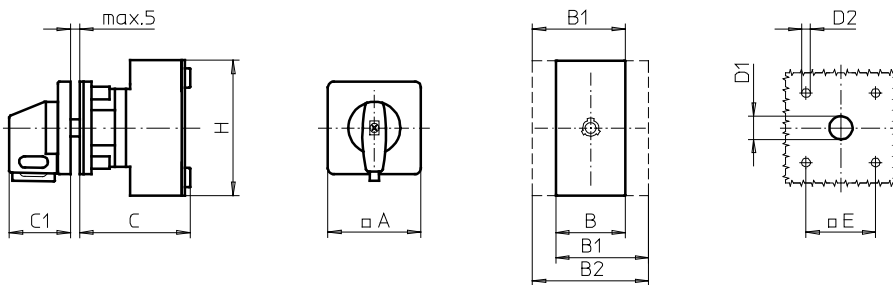
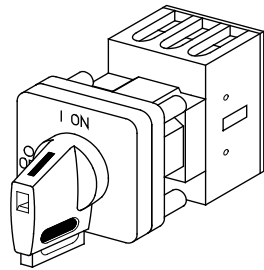

**Product lines  
H200-A/-B/-C**

**Front mounting switch**

**Four hole mounting**

36 × 36 mm

**033V1 (IP66)**

**033V4 (IP66)**

Complete switch	Poles	Product line	Rated data (IEC 60947)			Order code number				
			Operational current I <sub>e</sub>	Operational power at 380–440V						
			AC-21A A	AC-23A kW	AC-3 kW					
Main Switches OFF position padlockable 09h	3 ... 4	H200-C	20	5,5	3,7	<b>H212 - 41 ... - 033V1</b>				
	3 ... 4	H200-A	20	5,5	3,7	<b>H216 - 41 ... - 033V1</b>				
			25	7,5	5,5	<b>H220 - 41 ... - 033V1</b>				
			32	11	7,5	<b>H226 - 41 ... - 033V1</b>				
			40	15	11	<b>H233 - 41 ... - 033V1</b>				
			63	22	18,5	<b>H263 - 41 ... - 033V1</b>				
Main/Emergency-Off Switches OFF position padlockable 09h	3 ... 4	H200-C	20	5,5	3,7	<b>H212 - 41 ... - 033V4</b>				
	3 ... 4	H200-A	20	5,5	3,7	<b>H216 - 41 ... - 033V4</b>				
			25	7,5	5,5	<b>H220 - 41 ... - 033V4</b>				
			32	11	7,5	<b>H226 - 41 ... - 033V4</b>				
			40	15	11	<b>H233 - 41 ... - 033V4</b>				
			63	22	18,5	<b>H263 - 41 ... - 033V4</b>				
<b>SMD modules for basic switch A02</b>										
Mounting form module for 033V.			H200-A H200-B /-C		<b>BFA2 - 003</b> <b>BFB2 - 003</b>					
V-operator module 48 × 48 mm, mounting form 033V1 Escutcheon black, handle black			H200-A/-B/-C		<b>2AV1 - 09</b>					
Legend plate silver, operator module 033V1					<b>FAS2 - 9078</b>					
V-operator module 48 × 48 mm, mounting form 033V4 Escutcheon black, handle red					<b>2AV4 - 09</b>					
Legend plate yellow, operator module 033V4					<b>FBS2 - 9078</b>					
<b>Dimensions (mm)</b>										
<b>Product lines</b>	<b>A</b>	<b>B</b>	<b>B1</b>	<b>B2</b>	<b>C</b>	<b>C1</b>	<b>D1</b>	<b>D2</b>	<b>E</b>	<b>H</b>
H200-A	48	36	48	60	58	32	12	4,5	36	70
H200-B	48	50	69	88	58	32	12	4,5	36	72
H200-C	48	45	-	-	50	32	12	4,5	36	45