

# Front Mounting Switches

# sälzer

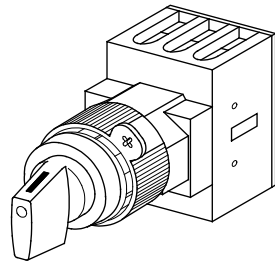

**Product lines  
H200-A/-B/-C**

**Front mounting switch  
with front ring**

**Single hole mounting  
ø 30,5 mm**

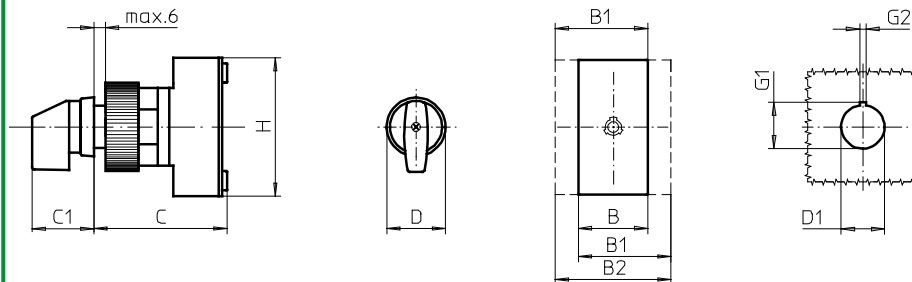

**208M1 (IP66)**

Complete switch	Poles	Product lines	Rated data (IEC 60947)			Order code number
			Operational current I <sub>e</sub>	Operational power at 380–440V		
			AC-21A A	AC-23A kW	AC-3 kW	
ON-OFF Switches Switching angle 90°	3 ... 4	H200-C	20	5,5	3,7	<b>H212 - 41 ... - 208M1</b>
		H200-A	20	5,5	3,7	<b>H216 - 41 ... - 208M1</b>
	25		7,5	5,5	<b>H220 - 41 ... - 208M1</b>	
	32		11	7,5	<b>H226 - 41 ... - 208M1</b>	
	40		15	11	<b>H233 - 41 ... - 208M1</b>	
	3 ... 4	H200-B	63	22	18,5	<b>H263 - 41 ... - 208M1</b>

SMD modules for basic switch A01			
Mounting form module for 208M1		H200-A H200-B/-C	<b>BFA2 - 219</b> <b>BFB2 - 219</b>
Front ring black ø 39,5 mm M-handle black, mounting form 208M1 (Front ring without inscription)		H200-A/-B/-C	<b>2HM1 - 30</b>

Dimensions (mm)										
Product lines	B	B1	B2	C	C1	D	D1	G1	G2	H
H200-A	36	48	60	75	32	39,5	30,5	33	4,8	70
H200-B	50	69	88	75	32	39,5	30,5	33	4,8	72
H200-C	45	-	-	70	32	39,5	30,5	33	4,8	45