

# Front Mounting Switches

**sälzer**

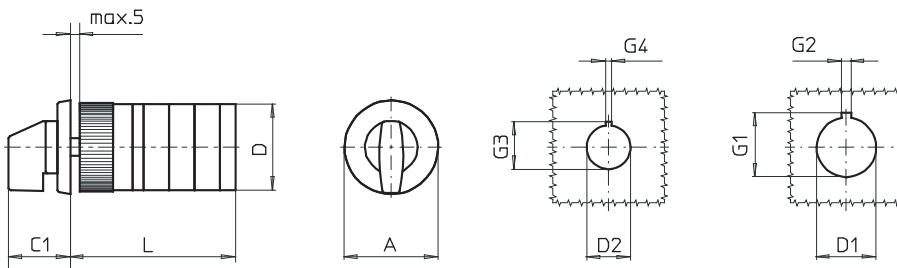
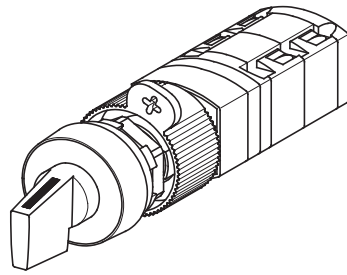

**Product line  
P100**

**Front mounting switch  
with front ring**

**Single hole mounting  
ø 16 mm / 22,5 mm**

**218M1 (IP66)**

Complete switch	Poles	Product line	Rated data (IEC 60947)			Order code number								
			Operational current I <sub>e</sub>	Operational power at 380-440V										
			AC-21A A	AC-23A kW	AC-3 kW									
Rotary Cam Switch Switching angle 30°/45°/60°/90°	1 ... 16	P100	10	3	2,2	<b>P110 - 61 ... - 218M1</b>								
<b>SMD modules for basic switch A01</b> Mounting form module for 218M1 Frontring black ø 30 mm, M-handle black, mounting form 218M1 (mounting with front ring without inscription)			P100			<b>BFA1 - 219 1DM1</b>								
<b>Dimensions in mm</b>														
<b>Type</b>	<b>A</b>	<b>C1</b>	<b>D</b>	<b>D1</b>	<b>D2</b>	<b>G1</b>	<b>G2</b>	<b>G3</b>	<b>G4</b>	<b>L with ... stages (max. 8)</b>				<b>each add. stage</b>
P110	30	26	29	22,5	16,2	24,2	3,2	17,9	1,7	<b>1</b>	<b>2</b>	<b>3</b>	<b>4</b>	12