

# Front Mounting Switches

**sälzer**

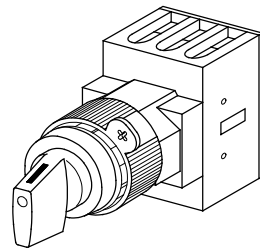

**Product lines  
H200-A/-B/-C**

**Front mounting switch  
with front ring**

**Single hole mounting  
ø 22,5 mm**

**218M1 (IP66)**

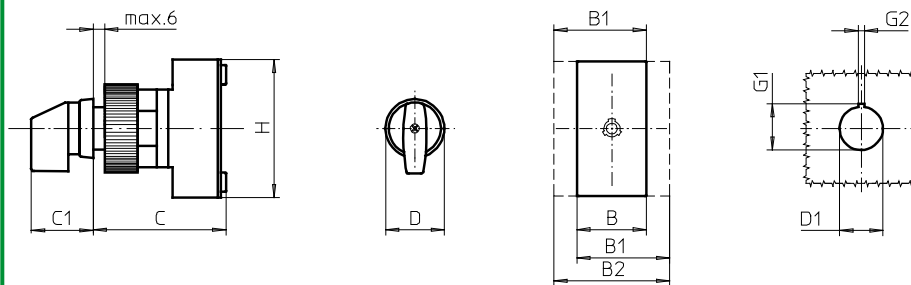

Complete switch	Poles	Product lines	Rated data (IEC 60947)			Order code number
			Operational current I <sub>e</sub>	Operational power at 380–440V		
			AC-21A A	AC-23A kW	AC-3 kW	
ON-OFF Switches Switching angle 90°	3 ... 4	H200-C	20	5,5	3,7	<b>H212 - 41 ... - 218M1</b>
		H200-A	20	5,5	3,7	<b>H216 - 41 ... - 218M1</b>
	3 ... 4	H200-B	25	7,5	5,5	<b>H220 - 41 ... - 218M1</b>
			32	11	7,5	<b>H226 - 41 ... - 218M1</b>
			40	15	11	<b>H233 - 41 ... - 218M1</b>
			63	18,5	15	<b>H263 - 41 ... - 218M1</b>

## SMD modules for basic switch A01

Mounting form module for 218M1

H200-A  
H200-B/-C  
H200-A/-B/-C

**BFA2 - 219**  
**BFB2 - 219**  
**2HM1**

Front ring black ø 30,5 mm  
M-handle black, mounting form 218M1  
(Front ring without inscription)

## Dimensions (mm)

Product lines	B	B1	B2	C	C1	D	D1	G1	G2	H
H200-A	36	48	60	75	31,5	31	22,5	24,2	3,2	70
H200-B	50	69	88	75	31,5	31	22,5	24,2	3,2	72
H200-C	45	-	-	70	31,5	31	22,5	24,2	3,2	45